

# FUTURE ARMADA

DELUXE STARSHIP DESIGNS



## EXETER TRAMP FREIGHTER

6

Uses the Open Game License to present familiar stats for ship & crew.

OGL  
SCI-FI

## Demo Document for Future Armada: Exeter

by Ryan Wolfe of “zero hour” art & technology

**0-hr.com**

*Future Armada: Exeter* is copyright © 2006, Ryan Wolfe

This ship was inspired by the *Barrett*, designed  
by Ken Snellings.

### Overview

The purpose of this document is to show you what you can expect should you choose to invest in *Future Armada: Exeter*. The images on the following pages are low-resolution “print-preview” screen captures meant to provide a general idea of what is inside each book.

Specifically, this is what you’re looking at:

- **Page 3:** Main Book. This provides OGL (using the Open Game License) statistics for the ship and crew. Brief descriptions are given for each area of the vessel, and composite maps are provided so it is easy to put the pieces together. Statistics and map are also provided for the ship’s shuttle.
- **Page 4 (left side):** Color Maps. The map book provides tactical maps (1 inch = 5 ft.) for the interior areas of the ship. The screen shot shows a sampling of the pages, laid out like they would be when assembled.
- **Page 4 (right side):** Printer Friendly Maps. A black-and-white version of the color map book is provided. The right side of the image shows the same pages from the Black-n-White book.
- **Page 5:** Sample Map. This is a single page from the color map book, ready to be printed out and used with miniatures. The maps are designed to be laid end-to-end as needed.
- **Page 6:** Bonus Art. Two of the rendered 3D exterior views are shown. The actual pictures are 800x600 jpeg images.

Thank you for taking the time to explore this product. I hope that the tramp freighter *Exeter* can become a memorable part of your campaign!

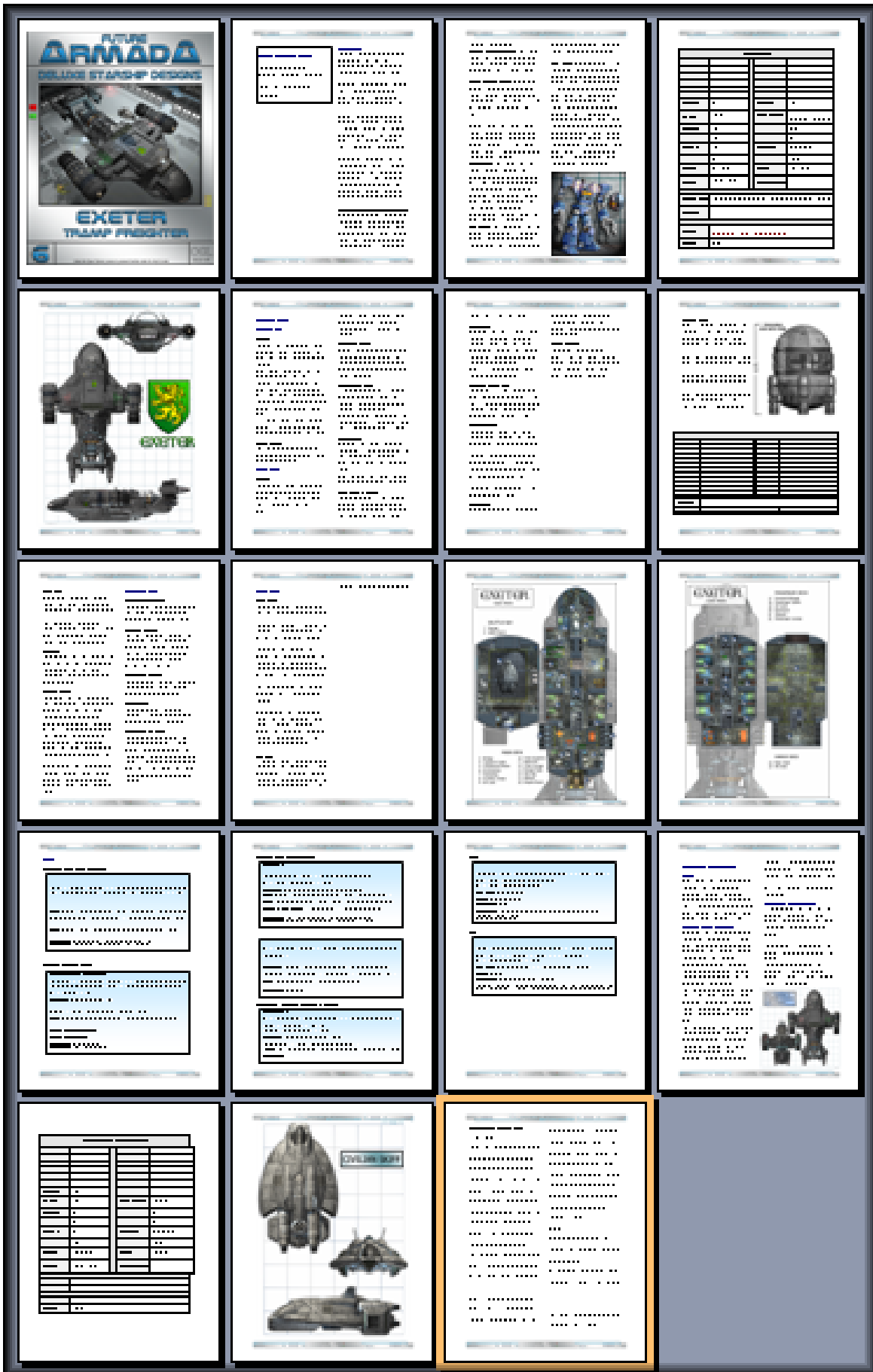

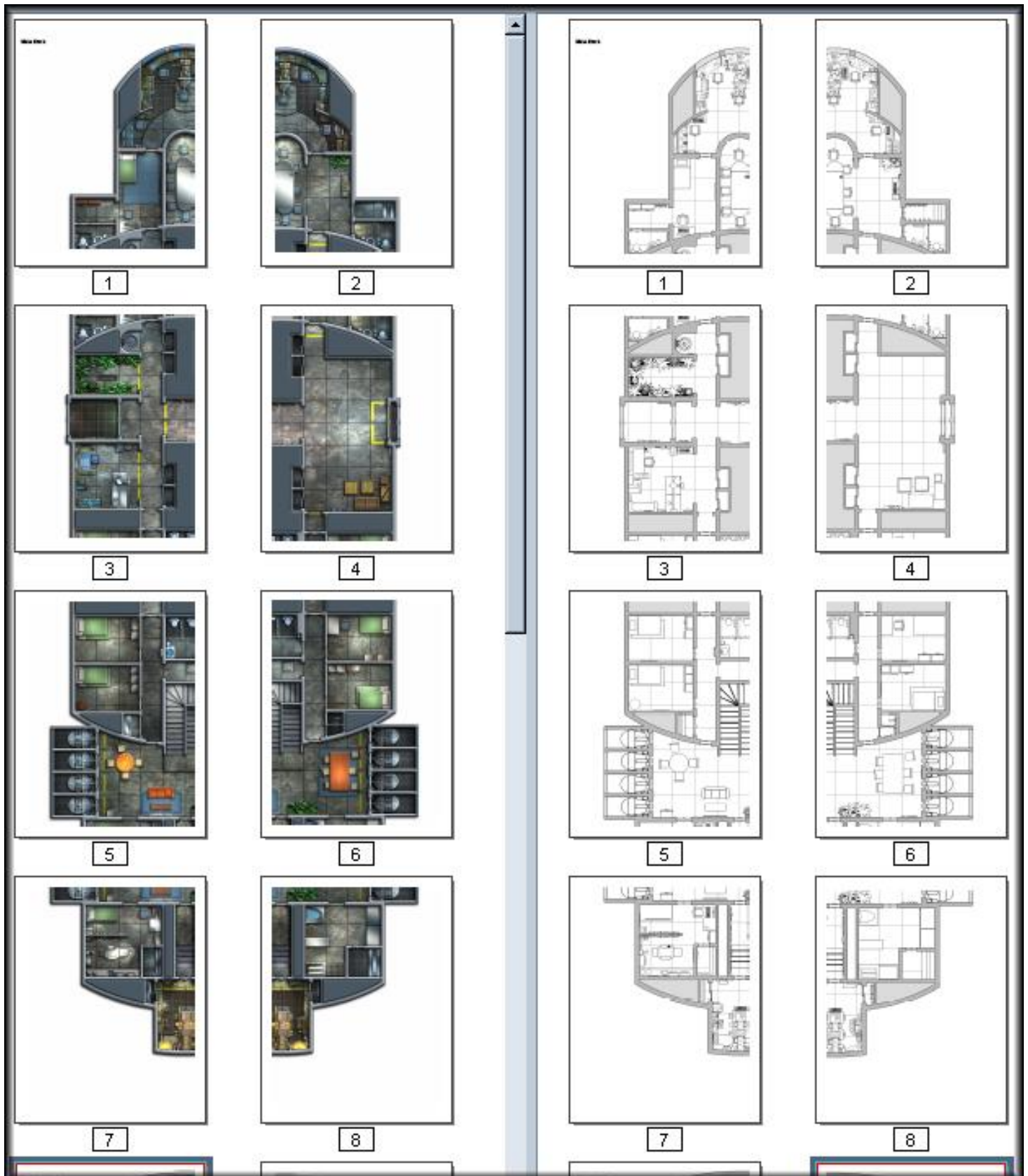





## Bonus Art



# EXETER

## Tramp Freighter

Exeter is a family owned and operated tramp freighter that has been in service for more than 50 years. Designed by the same shipyards that produced the Clydesdale class gunboat, this vessel was built from the ground up to haul cargo and passengers efficiently throughout civilized space. It is far from luxurious but the service is decent and ship runs on time. It has developed a reputation for dependability and a no-questions-asked policy when it comes to custom charters to out of the way locations.

At 228 feet long, this PL-6 freighter has room for a crew of up to eight as well as twenty passengers in the default configuration. There are also freight-only and passenger-only variants, both of which can be represented using the standard map pages. Exeter comes with a 30 ton, five person skiff and a pair of handy robots to help with the more tedious jobs. Wherever you need to go, Exeter can take you there!

The .zip file contains the following:

- Overview
  - 19 page PDF file detailing the ship, interior locations, and personnel.
  - Open Game License stats provided for the vessel and crew, as well as the shuttle craft and an armed configuration.
- Map Book
  - Full-color 25 page PDF file containing complete interior maps.
  - Includes miniature-scale maps for tactical combat.
  - Broken into pages for easy printing.
- Printer friendly, black and white version of the map book.
- Miniature-scale composite maps of the ship interior.
  - A 24x36 inch, 150 dpi, color JPEG image of the upper two decks.
  - A 24x36 inch, 150 dpi, color JPEG image of the lower two decks.
- "Bonus Art" directory with half a dozen rendered images of the freighter and skiff.

*Starfinder* stats, demo documents, and art are available free at **0-hr.com**

This ship will serve as a ready-made vessel for use by either game masters or players. While OGL statistics are provided, they kept are separate for easy modification or replacement. So let Exeter set sail in the space lanes of whatever system you choose.